



3

ω

- 2

Connector dimension

2

Country

Protection & Control List

PN: 8D025K08SAL

A

6 First Release

ISS

Latest modification - by	
--------------------------	--

MOD N°	
--------	--

Date:

Stainless Steel Receptacle 8D series

NPRDS / PROJECT
859

WWW.SOURIAU.COM

SOURIAU DRG N°
8D025K08SAL-C

SHEET
1/2

BASIC SERIES:

8D

0

2.

K

30

S

A

L

Delivered W/O Contacts

SHELL TYPE : Square Flange Receptacle

CONTACT TYPE : Standard Crimp Contact

ORIENTATION : A

SHELL SIZE : 25

CONTACT TYPE : SOCKET(500 Matings)

PLATING : K = Passivated

CONTACT LAYOUT : 25-08

Contact Layout

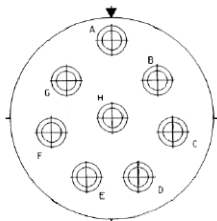

Inactive for new design for MIL-DTL-38999. For new design, use arrangement no. 25-10.)

Contact position ID	Contact location	
	X-axis (mm)	Y-axis (mm)
A	-000 (0.00)	-426 (10.92)
B	+333 (8.46)	+266 (6.76)
C	+415 (10.54)	-095 (2.41)
D	+185 (4.70)	-384 (9.75)
E	-185 (4.70)	-384 (9.75)
F	-415 (10.54)	-095 (2.41)
G	-333 (8.46)	+266 (6.76)
H	+000 (0.00)	+000 (0.00)

Shell size	Arrangement no.	Number of contacts	Size of contacts	Service rating	Contact location	Standard contact	
						Pin	Socket
25	-8	8	8	Twinax	All	M39029/90-529	M39029/91-530

Panel Cutout

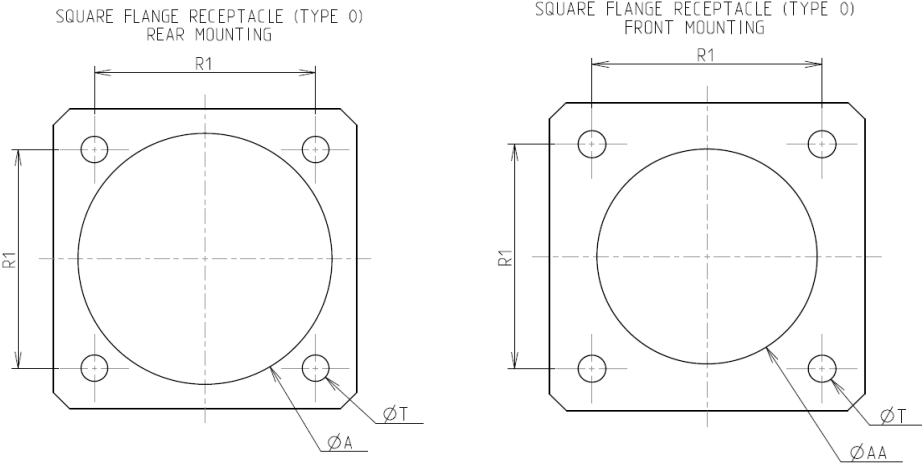

Dim	Nominal
ØA	42.47 min
ØAA	37.69 min
R1	38.1
ØT	3.81 ±0.13

SOURIAU shall not be liable for any non-conformity or damage due to a use of the Products which does not comply with the Specifications issued by either of the Parties or by a third party (professional recommendation, technical notice.)

Country	Jurisdiction & Control List
FR	Not Listed

PN: 8D025K08SAL

A	14-10-2016	First Release		
ISS	DATE	Latest modification - by		MOD N°
Designed By:		Date:	CUSTOMER DRAWING	
TITLE		Stainless Steel Receptacle 8D series		
SCALE		General linear Tolerances:	NPRDS / PROJECT	
NA		±--	859	
SOURIAU		WWW.SOURIAU.COM		This document is the property of SOURIAU it must not be reproduced or communicated without permission
FORMAT	SOURIAU DRG N° 8D025K08SAL-C			SHEET 2/2